

Frequently Asked Questions (FAQs)

(1) Is there any element of risk involved in getting members of public to put out the rubbish chute/bin fires?

A fire within a rubbish chute/bin is a smouldering fire that is typically small with no risk of spreading. Each year, about 20% of the rubbish chute and bin fires have already been put out by members of the public prior to SCDF's arrival at the scene. To date, there has been no reported injury arising from such small fires.

(2) Why is there a need for me to assist in putting out the rubbish chute/bin fires?

Annually, SCDF responds to more than 1,000 rubbish chute and bin fires. Such fires are typically very small in nature and could be easily put out by members of the public using available means such as pails of water or nearby taps and hoses. This will considerably free up scarce SCDF resources in enabling us to attend to victims in dire need of our help such as life-threatening emergencies.

(3) How would I know if the fire in the rubbish chute/bin has been successfully put out?

The fire would have been put out once there is no more smoke coming out from the rubbish chute/bin.

(4) Can rubbish chute/bin fires be prevented?

Such fires can be easily prevented by ensuring that flammable items such as paint and kerosene, or lighted materials like burning embers and cigarette butts are not thrown into the rubbish chutes/bins.

(5) How does the myResponder mobile app work?

The myResponder mobile app alerts registered responders to cases in their immediate vicinity (about 400 metres in radius). You can be activated to help extinguish a minor rubbish chute/bin fire, or to provide SCDF with photos and/or videos of incidents as they occur.

(6) How will I know what to do when I receive a myResponder mobile app alert?

Once you accept the case, the app will guide you to take the appropriate actions throughout the response process.

(7) If I do not know anything about firefighting, can I still help?

Yes, you do not need any prior training to be a Community First Responder. The minor rubbish fires can be easily put out using means available to the general public, and myResponder mobile app will guide you as you progress through the different steps of the response.

In your free time, you can also read the FAQs and tutorials within the app to better understand the process.

YOU CAN HELP PUT OUT MINOR RUBBISH FIRES

SCDF attends to more than a thousand minor rubbish fires a year. These fires are typically small with no risk of spreading.

Get notified of minor rubbish fires near you and be a Community First Responder.



Learn more about preventing rubbish fires.

A fire advisory message from:



Supported by:



Rubbish chute and bin fires are minor and can be easily put out

They are typically small with no risk of spreading. These fires can be put out by one of the following methods:

Method A

Fill a small pail or plastic bag with water. Drop the bag into the rubbish chute, or pour the pail of water onto the fire.



Method B

Use a fire extinguisher, and direct the nozzle towards the base of the fire.



Method C

Use a nearby tap and hose, or a hosereel to douse the fire.



Method D

Activate the drencher system for rubbish chutes if they are available. Drencher systems can be activated from the ground floor rubbish collection chamber.

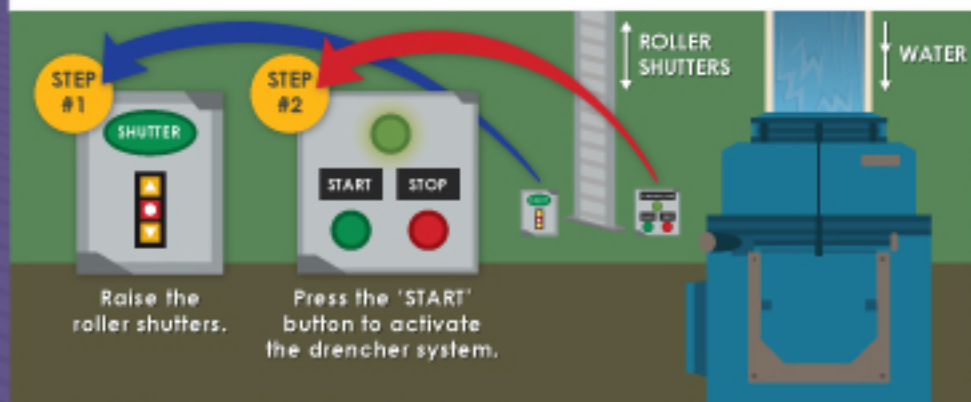

Repeat any of these steps until there is no more smoke

You can help to prevent such fires from occurring by not throwing flammable items like paint and kerosene, or lighted materials such as burning embers and cigarette butts into the rubbish chute/bin.

Get notified of minor rubbish fires near you!

Be a Community First Responder (CFR) and get notified of minor rubbish fires via the myResponder mobile application.

Download the myResponder mobile application from Apple or Google app stores.



1

Sign in to the application.



2

Register for alerts.



3

Select **YES** to receive alerts for fires near you.

Get notified of nearby fires.



4

By putting out the minor rubbish fires in your neighbourhood, you are helping to free up the scarce SCDF resources to attend to more pressing cases such as life-threatening emergencies.

For more information on the myResponder mobile application, visit:

https://www.scdf.gov.sg/community_volunteers/mobile_apps

